

## RIVET NUTS ESF - FLAT HEAD

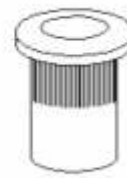
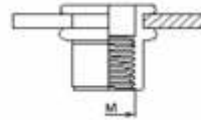
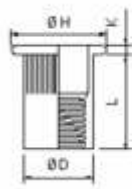
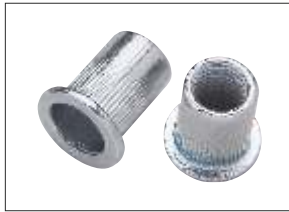

THREAD SIZE	CODE NO	GRIP RANGE	HOLE DIAMETER	L	D	H	K
M3-0,5	ESF - 320	0,3 - 2,0	5,0	9,8	4,90	8,0	0,8
M4-0,7	ESF - 430	0,3 - 3,0	6,0	10,8	5,90	9,0	0,8
M5-0,8	ESF - 530	0,3 - 3,0	7,0	12,0	6,90	10,0	1,0
M6-1,0	ESF - 630	0,5 - 3,0	9,0	14,5	8,90	13,0	1,5
M8-1,25	ESF - 830	0,5 - 3,0	11,0	16,0	10,90	16,0	1,5
M10-1,5	ESF - 1035	1,0 - 3,5	13,0	18,0	12,90	18,5	2,2
M12-1,7	ESF - 1050	1,0-4,0	16,0	20,0	14,90	18,5	2,2

MATERIAL : STEEL

## RIVET NUTS ESC - REDUCED HEAD

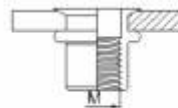
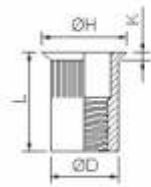

THREAD SIZE	CODE NO	GRIP RANGE	HOLE DIAMETER	L	D	H	K
M3-0,5	ESC - 320	0,3 - 2,0	5,0	10,3	4,90	6,0	0,5
M4-0,7	ESC - 430	0,3 - 3,0	6,0	11,3	5,90	6,7	0,5
M5-0,8	ESC - 530	0,3 - 3,0	7,0	12,7	6,90	7,8	0,6
M6-1,0	ESC - 630	0,5 - 3,0	9,0	15,3	8,90	10,0	0,6
M8-1,25	ESC - 830	0,5 - 3,0	11,0	17,3	10,90	12,0	0,6
M10-1,5	ESC - 1035	1,0 - 3,5	13,0	19,5	12,90	14,0	0,6

MATERIAL : STEEL

## REDUCED HEAD FULL - HEX BODY RIVET NUTS RHH-FHB

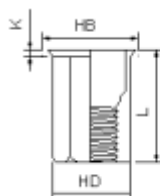

HOLE SIZE

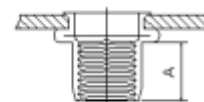
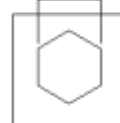

THREAD SIZE	CODE NO	GRIP RANGE	HOLE SIZE $^{+0,1}_{-0,0}$	A REF	HD	HB	K	L
M4X0,7	RHH - FHB - 0425	0,5 - 2,5	6,0	6,7	5,9	7,0	0,5	11,0
M5X0,8	RHH - FHB - 0530	0,5 - 3,0	7,0	9,0	6,9	8,0	0,5	14,5
M6X1,0	RHH - FHB - 0635	1,0 - 3,5	9,0	10,0	8,9	10,0	0,6	16,0
M8X1,25	RHH - FHB - 0840	1,0 - 4,0	11,0	11,5	10,9	12,0	0,6	18,0
M10X1,5	RHH - FHB - 1055	2,0 - 5,5	13,0	14,5	12,9	14,5	0,7	23,5

MATERIAL : STEEL